

Multipoint Locking Hardware for Sidelites
Edition 3

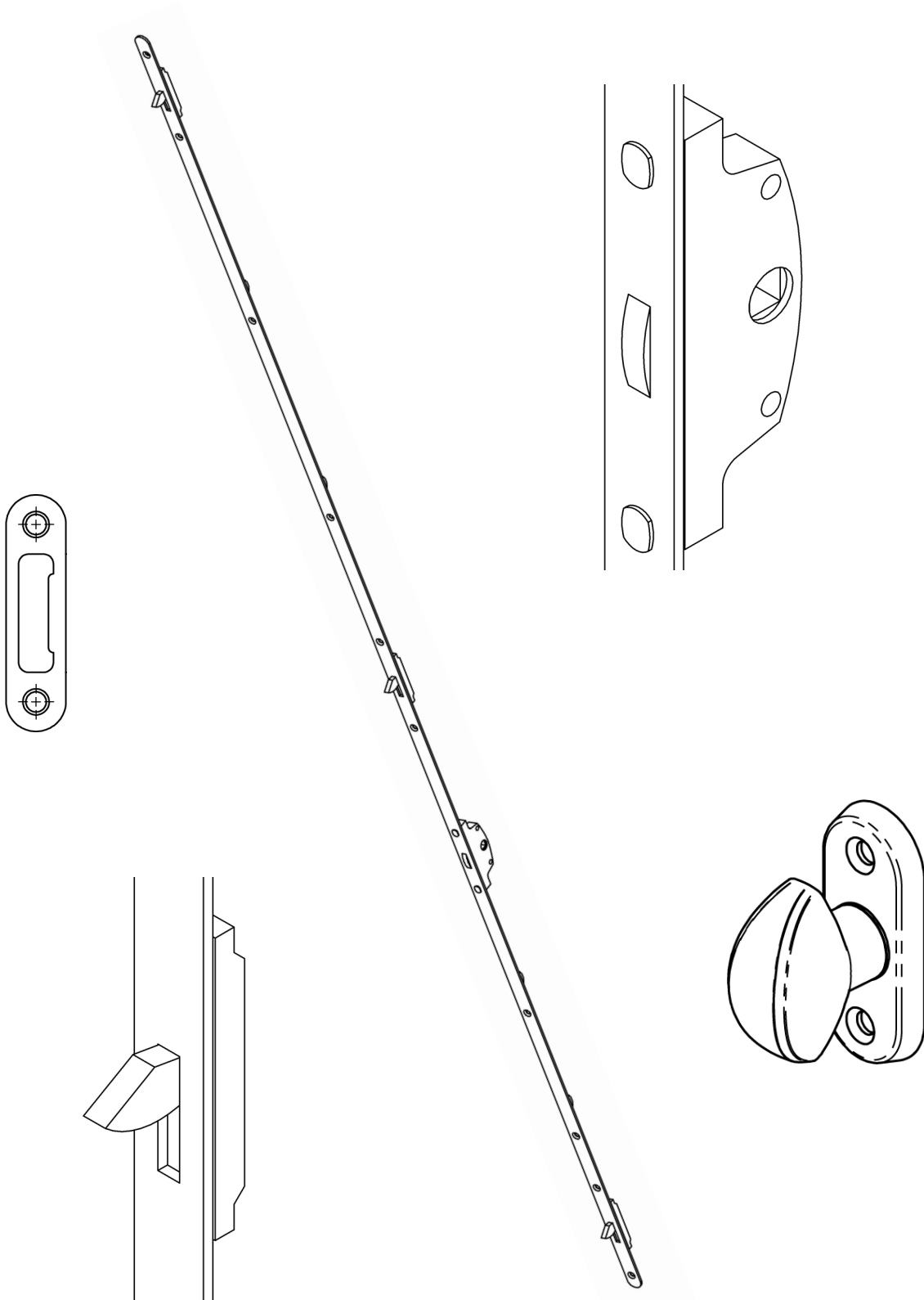

Sidelite Gears

P/N	Description	Backset	Overall Length	A1 1st Top Tongue	A2 2nd Top Tongue	B1 1st Bottom Tongue	B2 2nd Lower Tongue
3360992	20MM BS SZ60 TN2 550 F1 SC	20mm	550mm	202.5 mm	N/A	195.5 mm	N/A
3361004	20MM BS SZ100 TN3 950 F1 SC	20mm	950mm	402.5 mm	N/A	126.5 mm	395.5 mm
3307286	20MM BS SZ120 TN4 1150 F1	20mm	1150mm	302.5 mm	502.5 mm	126.5 mm	495.5 mm
3307294	20MM BS SZ140 TN4 1350 F1	20mm	1350mm	405.5 mm	602.5 mm	126.5 mm	595.5 mm
3528302	25MM BS SZ60 TN2 550 F1 SC	25mm	550mm	211.5mm	N/A	204.5mm	N/A
3528311	25MM BS SZ100 TN3 950 F1 SC	25mm	950mm	411.5mm	N/A	126.5mm	404.5mm
3528329	25MM BS SZ120 TN3 1150 F1 SC	25mm	1150mm	511.5mm	N/A	126.5mm	504.5mm
3528337	25MM BS SZ140 TN3 1750 F1 SC	25mm	1750mm	611.5mm	N/A	126.5mm	604.5mm
3317960	25MM BS TN3 1600 F1	25mm	1600mm	228.6mm	978.1 mm	469.9mm	N/A
3317978	25MM BS TN3 1676 F1	25mm	1676mm	1054.1mm	228.6mm	469.9mm	N/A
3548004	33MM BS TN 3 1448 F1 RC	33mm	1448mm	142.9mm	826.2mm	469.7mm	N/A
3548012	33MM BS TN 3 1613 F1 RC	33mm	1613mm	241.9mm	991.4mm	469.7mm	N/A

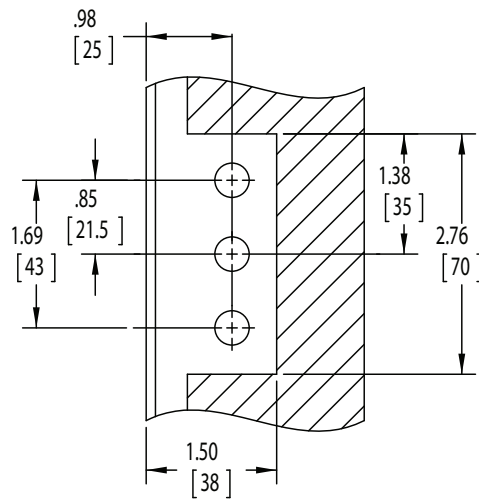
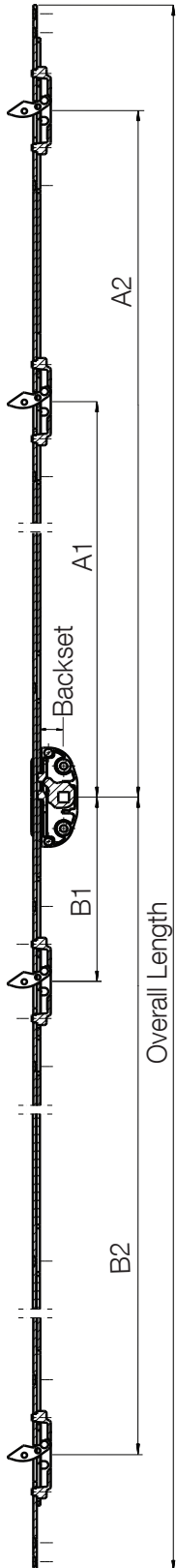

Mortise Prep

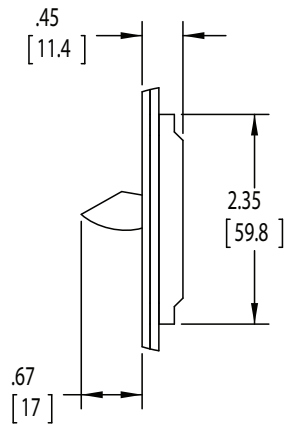

Tongue Detail

Features and Benefits

- Retractable lock points and concealed strikes provide a clean, continuous look – an advantage compared to other common types of sidelite hardware
- Two available gear sizes accommodate a wider range of panel heights
- Shallow 1" [25 mm] backset allows for narrow stile designs
- Multiple lock points maximize weather sealing capability
- Lock points are carefully positioned to avoid hinge hardware
- Radius end faceplates and strikes keep milling preparations simple and efficient
- Operating Knobs are available in 10 finishes to accompany any HOPPE swing door handle set
- Locking hardware is also compatible with any available HOPPE Window Handle for even more design options

Thumb Turns

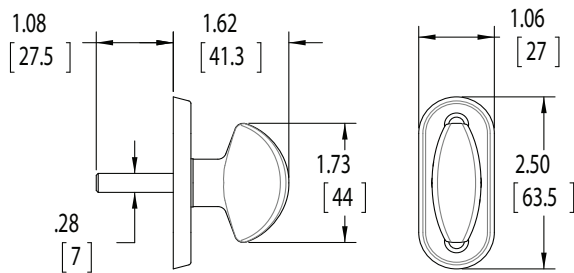

Finish	Part Number
Satin Nickel (F42-R)	3321387
Rustic Umber (F8709)	3321344
Oil Rubbed Brass (F79)	3321336
Brushed Chrome (F41)	3321281
Polished Brass (F77-R)	3321379
Matte Black (F9714)	3321361
Antique Brass (F73)	3321328
White (F9010)	3321352
Polished Chrome (F49)	3321301
Antique Nickel (F44)	3321310

Stainless Steel Strike
P/N 3317644

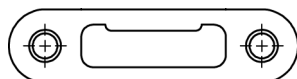

Dust Cap
P/N 3396750

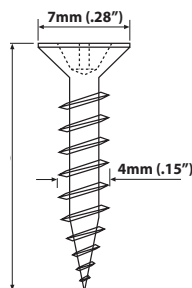
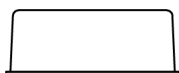

Fasteners for Locks

Part Number	Length	Package Quantity
8785711	.86" [22mm]	1000
8785715	.98" [25mm]	1000
8785719	1.37" [35mm]	1000

Fasteners for Strikes

Part Number	Length	Package Quantity
2045931	.75" [19mm]	1000



Handle of excellence.

HOPPE North America, Inc.
205 E. Blackhawk Drive
Fort Atkinson, WI 53538-1268

 920-563-2626

 920-563-4408

HOPPE North America, Inc.
6345 Netherhart Road
Unit #1
Mississauga, ON L5T 1B8
CANADA

 905-564-7344

 905-564-7301

 1-888-485-4885

 info@us.hoppe.com

 www.us.hoppe.com